

MF-30

– Mechanical Filter, wallmounted,

for two PlymoVent Ø 160 mm / 6.3" KUA/EA-arms

TECHNICAL DATA

Unit specification

Housing material: Galvanized steel
 Housing finish: Epoxy powder coat
 Unit weight: 49 kg / 108 lbs
 Unit dimensions: H: 857 mm / 33 3/4 inch
 W: 675 mm / 26 9/16 inch
 D: 712 mm / 28 inch
 Air volume: 2 x 800 - 1200 m³/h / 2 x 470 - 700 CFM
 Max. negative pressure: 4000 Pa / 16" wg
 Filter indicator: Manometer 0-2000 Pa / 0-8" wg

Filter elements:

Stage 1: Spark arrestor
 Stage 2: Pre-filter aluminium mesh
 Stage 3: Fine filter, glass fibre – GFMF
 95% ASHRAE/F9 EuroVent/BIA-C
 Final filter pressure: 800 Pa / 3.2" wg

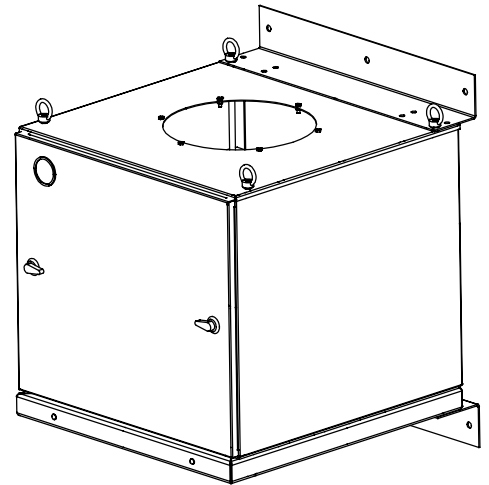

DIMENSIONAL DATA

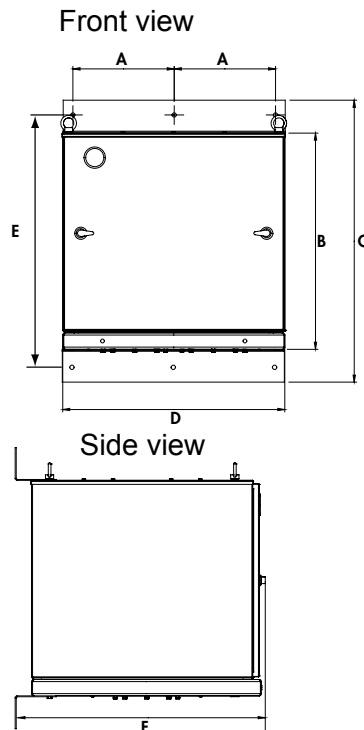

	mm	inch
A	308	12 1/8
B	657	25 7/8
D	675	26 9/16
E	767	30 3/16
F	760	29 29/32
G	50	2
H	354	13 29/32
I	362	14 1/4
J	220	8 11/16
K	240	9 7/16
L	340	13 3/8
M	376	14 13/16

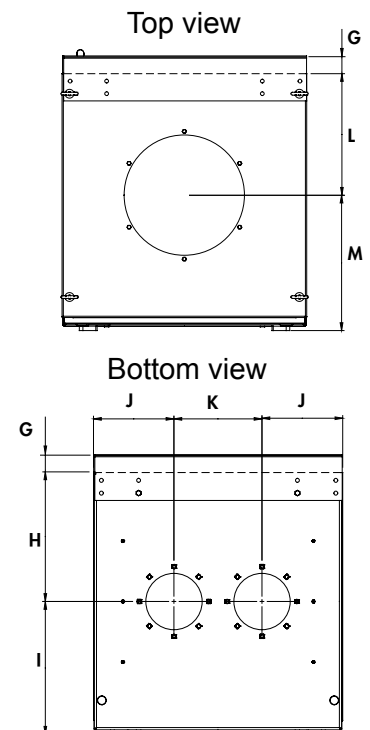

PlymoVent representative

PLYMOVENT[®]
 INTELLIGENT PROCESS VENTILATION™

PlymoVent Corp.
 375 Raritan Center Parkway
 Edison, N.J. 08837, USA
 Tel: +1 732 417 0808
 Fax: +1 732 417 1818
 info@plymovent.com
 www.plymovent.us.com

PlymoVent Inc
 6615 Ordan Drive, Unit #3
 Mississauga, ON. L5T 1X2, Canada
 Tel: +1 905 564 4748
 Fax: +1 905 564 4609
 info@plymovent.ca
 www.plymovent.ca